



HexForce

HYDRAULIC NUT SPLITTERS



BTS SERIES

- Compact design used in confined space with enough force to split the rusted nuts.
- All models feature a rugged one-piece cutting frame coupled to heavy-duty hydraulic cylinder.
- Specially designed "tool steel" cutter blade cuts the nut to the precise point where it cracks.
- Unique angled head design to keep full contact with the nut being penetrated.
- Unique angled cutter blade with radius to have greater resistance to cutting and breaking nuts.
- 5 popular models applicable to cover the most range of nuts.

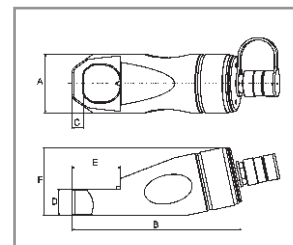

MODEL	HEXAGON NUT RANGE (mm)	BOLT RANGE (mm)	CAPACITY (TON)	OIL CAPACITY (c.c.)	A (mm)	B (mm)	C (mm)	D (mm)	E (mm)	F (mm)	WEIGHT (Kg)
BTS-1924	19-24	M12-M16	10	18	60	171.5	10	25	40	68	2.2
BTS-2432	24-32	M16-M22	15	40	70	192	13	30	52	79	3.3
BTS-3241	32-41	M22-M27	20	68	80	230	16	36	65	92	4.4
BTS-4150	41-50	M27-M33	35	150	100	286	21	45	76	116	8.2
BTS-5060	50-60	M33-M39	50	250	117	321	24	54.5	92	134	11.7

*The hardness of nut material must not excess HRC-44. Should not be used on stainless steel nuts and/or square shape nuts.



ADVANCED BOLTING SOLUTIONS PVT. LTD.

HO: "ABS House", Plot No. W-116 (A),
T.T.C. Industrial Area, MIDC Khairane,
Navi Mumbai - 400 710.

Phone: +91 82828 29795
E-mail: lead@absgroup.in
Web: www.absgroup.in